

***You Are Not
Alone.***

***High Point will be
there with you every
step of the way as
you address your
addiction and/or
mental health
issue.***

***Our comprehensive
continuum of care is
designed to support
you at every level.***

***Whatever your
needs, High Point
can help.***

OUTPATIENT SERVICES

at
Meadowbrook Campus

High Point Outpatient Clinic is at
10 Meadowbrook Road

Services include

- Individualized therapy for adolescents & adults
- Substance abuse
- Psychiatry
- Day treatment
- Mental health
- Driver alcohol education
- Early recovery group
- Medication management

Phone: 508-742-4420

COMMUNITY-BASED SERVICES

→ **SHARES** (Surviving Homicide's Aftermath: Resources, Education & Support)

→ **Brockton Mayor's Opioid Overdose Prevention Coalition**

Meadowbrook Behavioral Health Campus



**10-20-30 Meadowbrook Road
Brockton, MA 02301**

**Adjacent to
Campello
Commuter Rail Station**

An affiliate of
Southeast Regional Network



Men's Addiction Treatment Center

10 Meadowbrook Road
Admissions: 508-742-4400

Substance use disorder treatment services for civilly-committed (Section 35) men

Services include

- Medical detoxification
- 24-hour nursing care
- Dual diagnosis services
- 3 levels of care (ATS, CSS, TSS)
- Individual counseling
- Group therapy
- Psycho-educational groups
- Case management
- Aftercare planning
- Family therapy
- Family education night
- Transportation services for clients

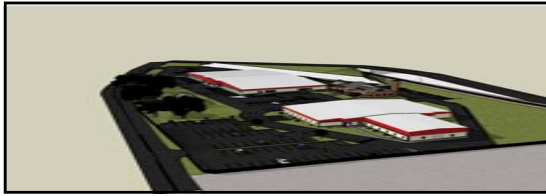

The CASTLE

20 Meadowbrook Road
Admissions: 508-638-6000

A short-term stabilization program for ages 13-17 with a substance use disorder diagnosis

Services include

- Medical detoxification
- Addiction services
- Acute stabilization services
- Dual diagnosis services
- Psychiatry
- Pediatric medicine
- Psycho-educational groups
- Individual & group counseling
- Family therapy
- Section 35 services
- Case management
- Aftercare planning
- 12 Step meetings
- Traditional AA commitments

Brockton Addiction Treatment Center

30 Meadowbrook Road
Admissions: 508-584-9210

Clinical support services (CSS) for men & women

Services include

- 24-hour clinical rehabilitation
- 24-hour nursing care
- Psycho-educational groups
- Development of enhanced treatment plans
- Drug assessments
- Recovery lectures & workshops
- Individual & group counseling
- 12 Step education
- Relapse prevention
- Case management
- Alcohol prevention
- Opioid overdose prevention
- Aftercare planning

Most insurances accepted, including MassHealth

~ Sliding fee scale ~